

C02 Sensor (MBS-K30) User Manual



MBS-K30 for Carbon-X CO2 Alarm System

OVERVIEW

Thank you for purchasing our MBS-K30 CO2 sensor.

The MBS-K30 CO2 sensor is specially designed to be used with the Carbon-X system to measure the CO2 PPM within the growing area. It can read up to 30,000 ppm CO2 is critical to the proper operation and safety of an emergency CO2 system (Carbon-X).

It incorporates an NDIR 0-30,000 ppm sensor in a self-aspirated enclosure.

It can be used in combination with one or more DSC-1 CO2 device modules to measure CO2 level within the area, then connect and control the user's supplemental CO2 system using the Hydro-X control system. The built-in LCD display will constantly display the current CO2 level (ppm). Each zone/room monitored by the Carbon-X can have 1 or 2 MBS-K30 CO2 sensors installed to satisfy local code requirements.

FEATURES

- LCD Display, Simple Operation
- Built-In Photocell Detecting Day/Night Mode
- Plug & Play Design

PACKAGE CONTENTS

- 1 x MBS-K30
- 1 x 16ft RJ12 Cable
- 1 x T-Shape Splitter

CONNECTION

Use an RJ12 cable to connect the MBS-K30 to the SPH-1 splitter hub for supplemental power, then connect the splitter hub to the main controller using an RJ-12 cable. The MBS-K30 should be connected to the controller through an SPH-1 as illustrated below.

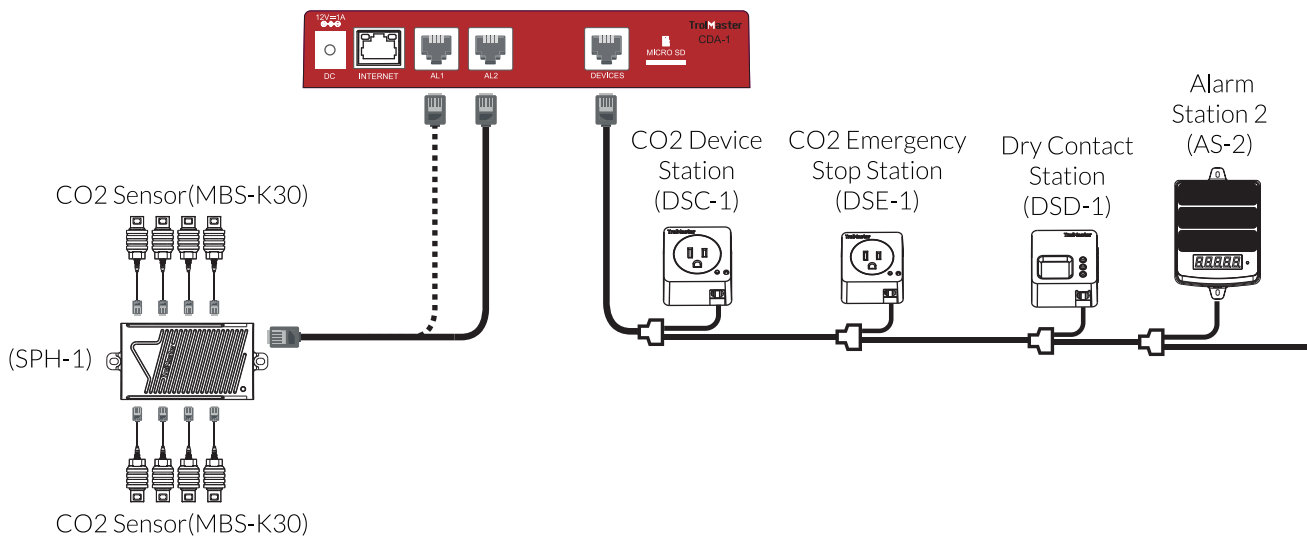

WARNING

DO NOT allow the MBS-K30 Dry Contact Board to be exposed to water or excessive heat. DO NOT open or attempt to repair or disassemble the controller, as there are no user-serviceable parts inside. Opening the controller will void the warranty.

If the surface of MBS-K30 Dry Contact Board is dirty, wipe it with a dry towel. The MBS-K30 Dry Contact Board operates under natural ventilation conditions.

AVERTISSEMENT

NE PAS exposer la carte de contact sec MBS-K30 à l'eau ou à une chaleur excessive. NE PAS ouvrir ou tenter de réparer ou de démonter le contrôleur, car il ne contient aucune pièce réparable par l'utilisateur. L'ouverture du contrôleur annulera la garantie.

Si la surface de la carte de contact sec MBS-K30 est sale, essuyez-la avec une serviette sèche. La carte de contact sec MBS-K30 fonctionne dans des conditions de ventilation naturelle.

For any issues or concerns with our products, DO NOT return them to the store. Please contact our tech support department at support@trolmaster.com or call **877-420-9876**.

April 2025 ©2025 TrolMaster™ All rights reserved.