

Water Detector (WD-1) User Manual



OVERVIEW

Thank you for purchasing the TrolMaster's WD-1 Water Detector. The WD-1 water detector is an electronic device that is specially designed to detect the presence of water and provide an alert in time to allow the prevention of water leakage in the Aqua-X Irrigation Control System.

The default function of Water Detector (WD-1) is for leak detection and there is a triangle symbol shown in the LCD display of the Aqua-X Controller. When the WD-1 detects water leakage, it will send alarm message to your Smartphone one minute later. You can also check the alarm message in the Aqua-X Controller.

This unit could be assigned to any controlled output in the system to monitor the watering schedules. Two or more Water Detectors (up to 25pcs for each system) can be linked together in a "daisy chain," expanding the leak detection monitoring area.

PACKAGE CONTENTS

- 1x Water Detector (WD-1)
- 1x Touch Spot
- 1x RJ12 T-splitter
- 1x 16ft RJ12 Cable

FEATURES

- LCD Display, Easy Operation
- Addressing Button
- Water Leak Alarm

FRONT PANEL



INSTALLATION

Mount the water detector near the water reservoir or nutrient tank. Use a screw to mount the Water Detector on the wall or fix it through the top hole with a string.



OPERATION INSTRUCTIONS

1. Connection to Aqua-X

Connect the RJ12 cable (left) to the Water Detector terminal on the bottom panel of the Aqua-X Controller. The touch spot cable (right) can be used to connect to a single TSS-1 Touch Spot (sold separately) or use a T-Splitter to connect one more TSS-1 Touch Spot under one Water Detector.

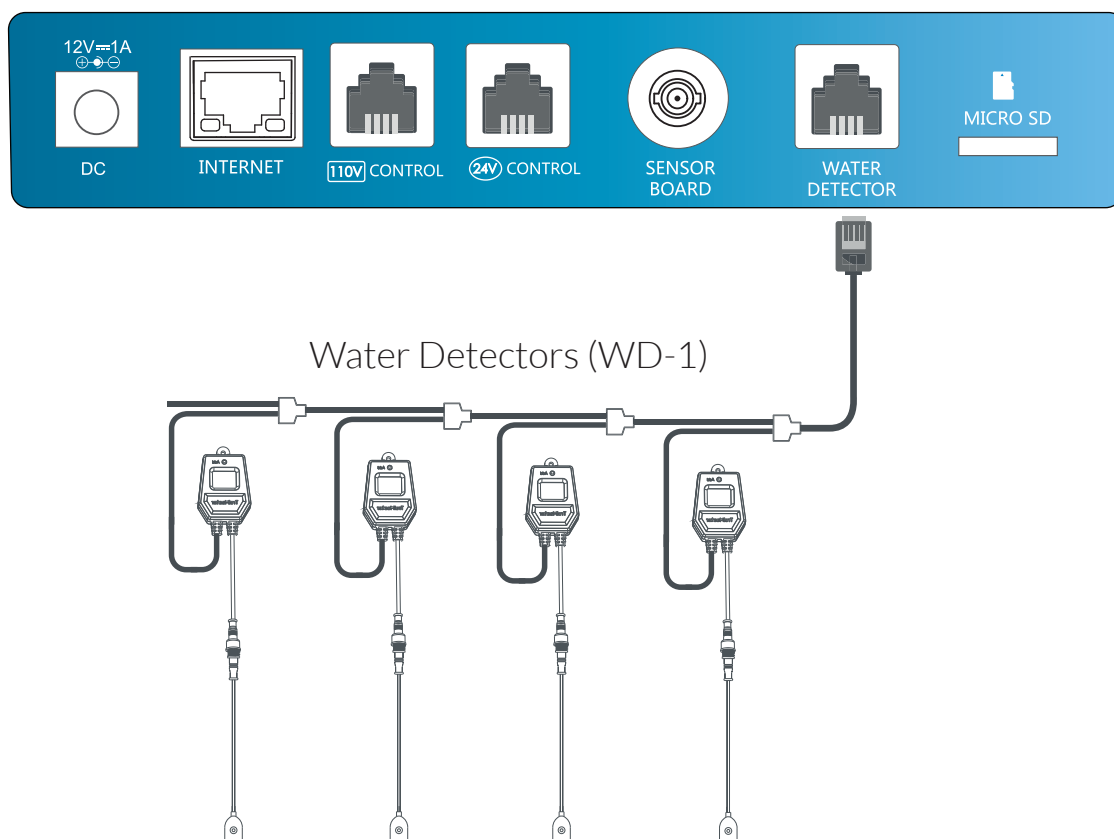

2. Address Assignment

Press the Addressing button on the WD-1 unit so that the Aqua-X Controller will assign an address to the WD-1 unit accordingly. The LCD screen of the WD-1 Water Detector will show a triangle symbol indicating that the water leak detection is the default function.

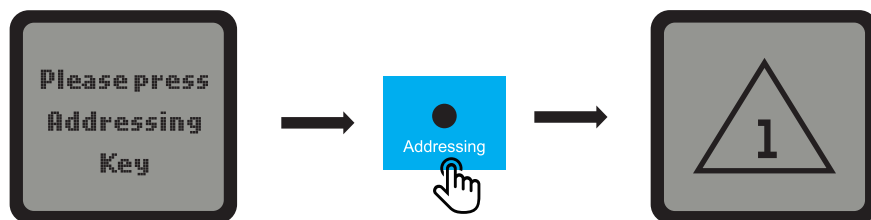

3. Leak Sensor & Assignment Settings

There are two functions for each Water Detector, one is Leak Sensor (water leak detection), the other is Assignment (assigned to any 24V or 110V controlled output) as illustrated below.

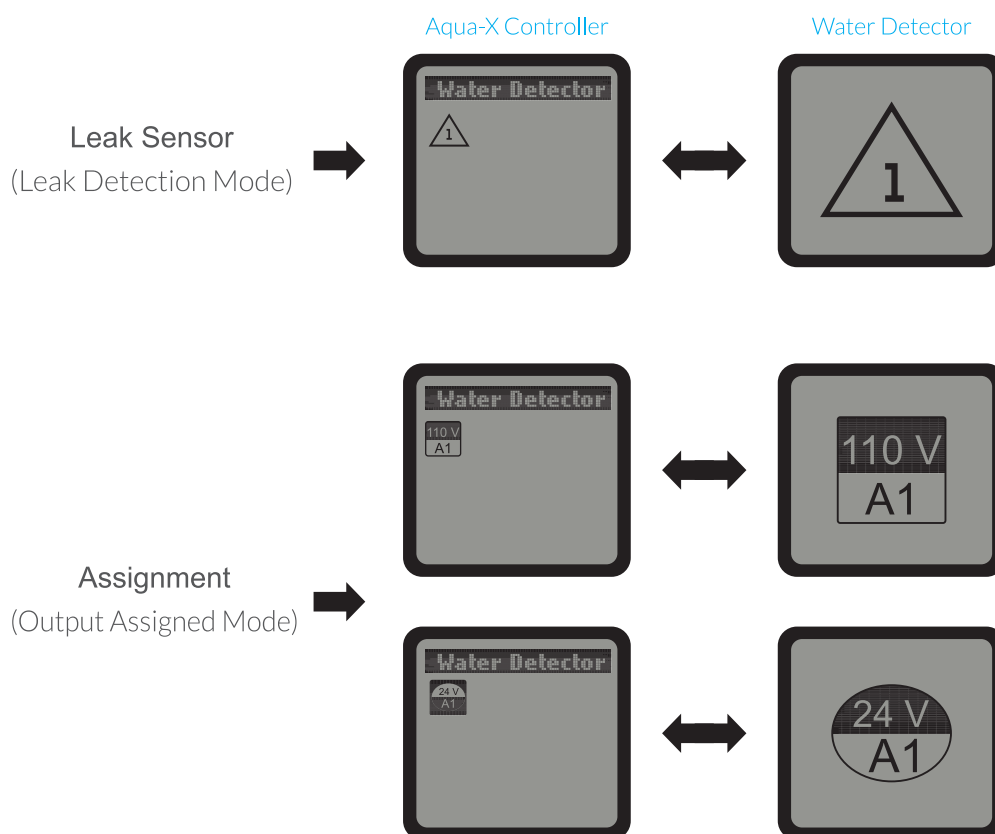

*** NOTE:** the number inside the triangle symbol refers to the connection sequence (from 1 to 25) of the water detectors. The first assigned Water Detector will be marked as number 1, and the second is number 2 and so on.

• Leak Sensor (Leak Detection Mode)

The default function of Water Detector (WD-1) is for leak detection and there is a triangle symbol shown in the LCD display of the Aqua-X Controller. When WD-1 detects water leakage, it will send an alarm message to your Smartphone one minute later. You can also check the alarm message in the Aqua-X Controller.

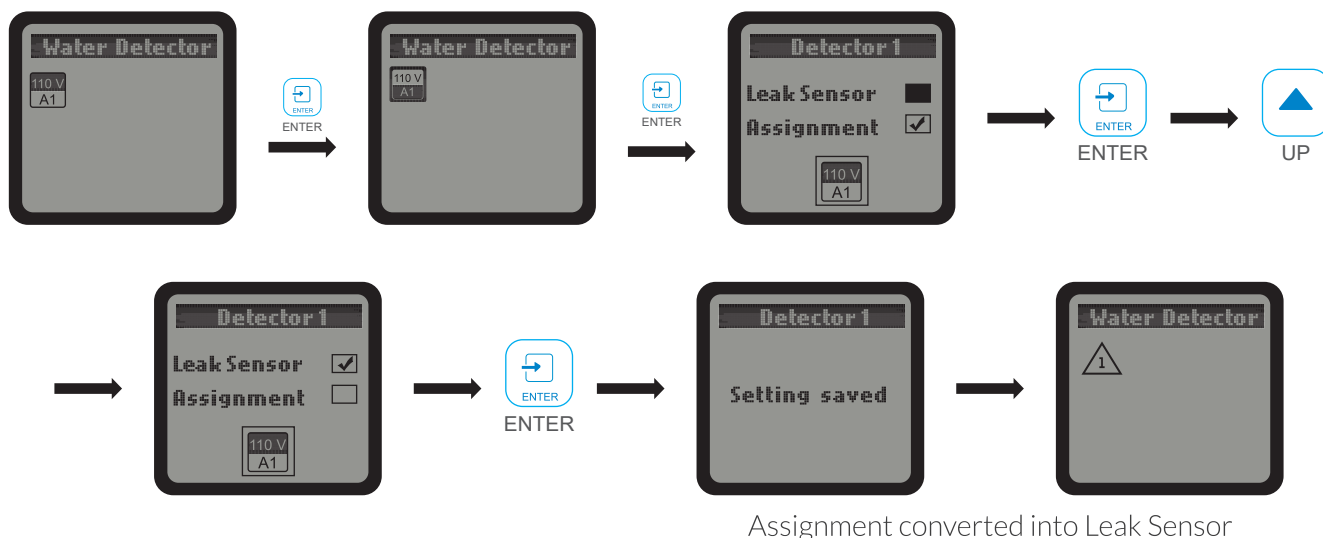

If the Water Detector is NOT in original default function (leak sensor), you can change the Assignment into Leak Sensor following the steps above.

• Assignment (Output Assigned Mode)

The default mode of Water Detector is in Leak Sensor (Leak Detection Mode). You can change the Leak Detection Mode (Leak Sensor) into Output Assigned Mode (Assignment) following the process below. As one Water Detector can be assigned to only one output on any Control Board, you need to select 24V or 110V and one of the six outputs to be assigned to the Water Detector. When the output has been successfully assigned, the Water Detector will send an alarm message to your Smartphone one minute later when it detects no water on the reservoirs of the irrigation system.

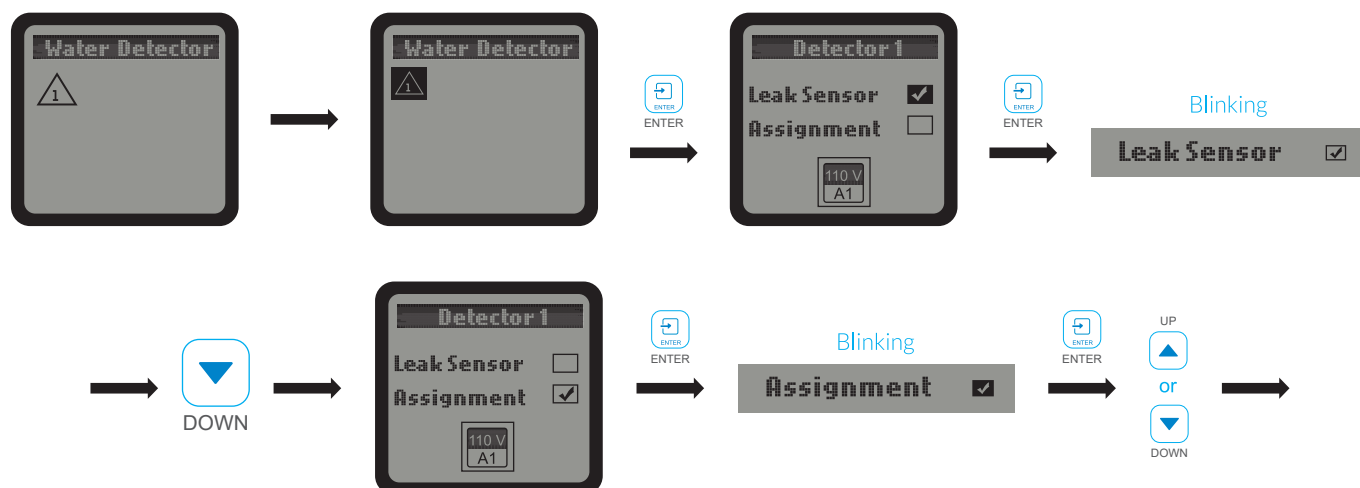

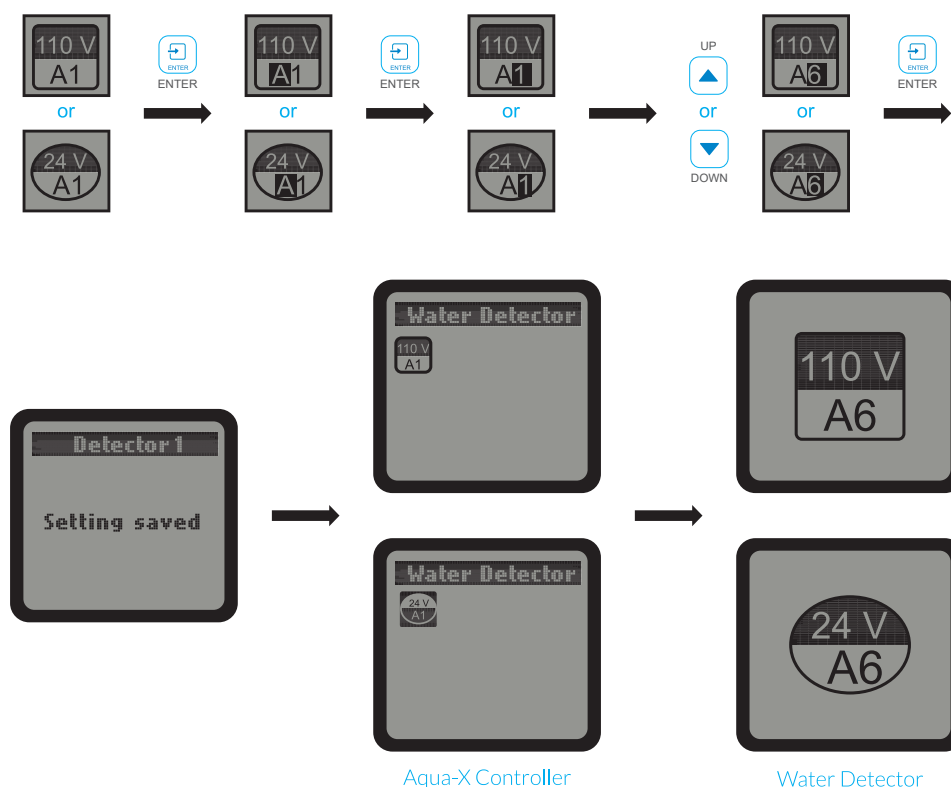

*** NOTES:**

- Each Water Detector can be assigned to a Control Board which has been successfully assigned to the Aqua-X Controller. The Water Detector can not be assigned to an unassigned Control Board.
- One Water Detector can be assigned to only one 24V or 110V output, One Aqua-X Controller can connect to 25pcs Water Detectors.
- If the assigned output of that board is offline, the output symbol will blink on the LCD display of the Aqua-X Controller.
- If the output is successfully assigned with the Water Detector and the Water Detector is connected with the Aqua-X Controller, there is a dot before the assigned output on the Control Board interface as below illustration.

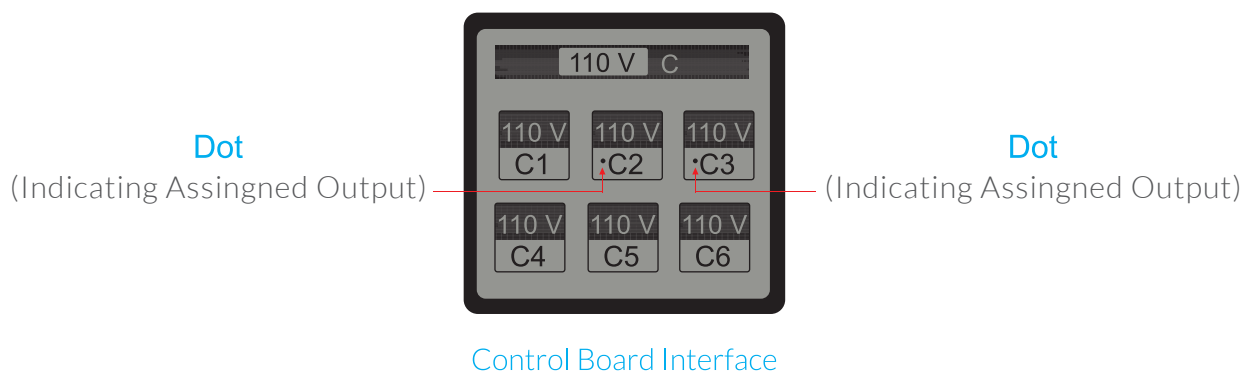

SPECIFICATIONS

Package Dimensions	160mm(L) x 86mm(W) x 86mm(H)
Ambient Temperature	32-122°F (0-50°C)
Relative Humidity	≤90%

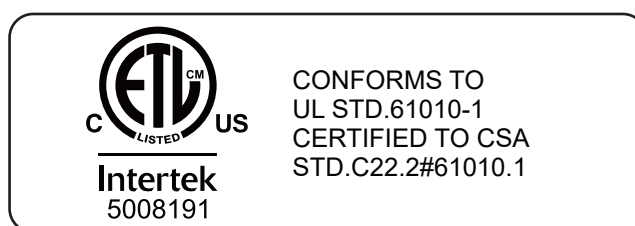

WARNING: DO NOT allow the WD-1 Dry Contact Board to be exposed to water or excessive heat. DO NOT open or attempt to repair or disassemble the controller, as there are no user-serviceable parts inside. Opening the controller will void the warranty.

If the surface of WD-1 Dry Contact Board is dirty, wipe it with a dry towel. The WD-1 Dry Contact Board operates under natural ventilation conditions.

AVERTISSEMENT: NE PAS exposer la carte de contact sec WD-1 à l'eau ou à une chaleur excessive. NE PAS ouvrir ou tenter de réparer ou de démonter le contrôleur, car il ne contient aucune pièce réparable par l'utilisateur. L'ouverture du contrôleur annulera la garantie.

Si la surface de la carte de contact sec WD-1 est sale, essuyez-la avec une serviette sèche. La carte de contact sec WD-1 fonctionne dans des conditions de ventilation naturelle.

For any issues or concerns with our products, DO NOT return them to the store. Please contact our tech support department at support@trolmaster.com or call 877-420-9876.

February 2025 ©2025 TrolMaster™ All rights reserved.