

DSD-3

Dry Contact Station

The DSD-3 Relay Device Station is a highly versatile peripheral driver designed to control the ON/OFF state of your terminal devices. Seamlessly integrating with TrolMaster's advanced ecosystem.

The DSD-3 allows for precise, automated environmental control. Featuring a single relay with both a normally open (NO) and a normally closed (NC) contact, the DSD-3 gives you the flexibility to easily switch between two channels, ensuring your grow room remains clean, reliable, and automated from day one.

DSD-3 provides a dry-contact output only; it functions solely as an isolated switch with a contact rating of 1A.



Specifications

DSD-3

Power Input

Input Voltage 12V $\overline{\text{DC}}$ 0.1A

NC/NO

NC/NO 1A@250VAC, 1A@30VDC

Package Contents

DSD-3	1pc
0.5ft RJ12 Cable	1pc
4ft RJ12 Cable	1pc
2EDGKNH-3.5mm_2x2P	1pc

Package Dimensions

Size 5.51inch / 140mm(L) x 3.54inch / 90mm(W) x 1.97inch / 50mm(H)

Operating Environments

Temperature 32~104°F (0~40°C)
Humidity ≤90%RH

Gross Weight 0.44lbs / 0.20kg

Link Up

DSD-3

Connection Diagram

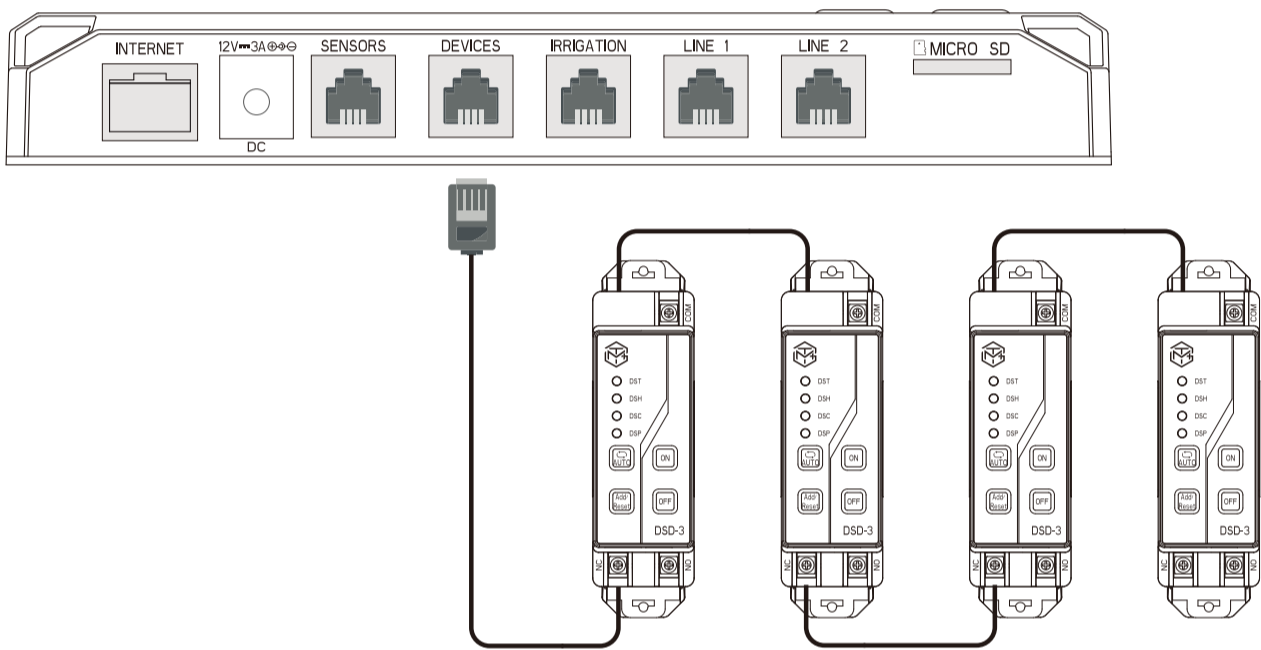

Product Dimensions

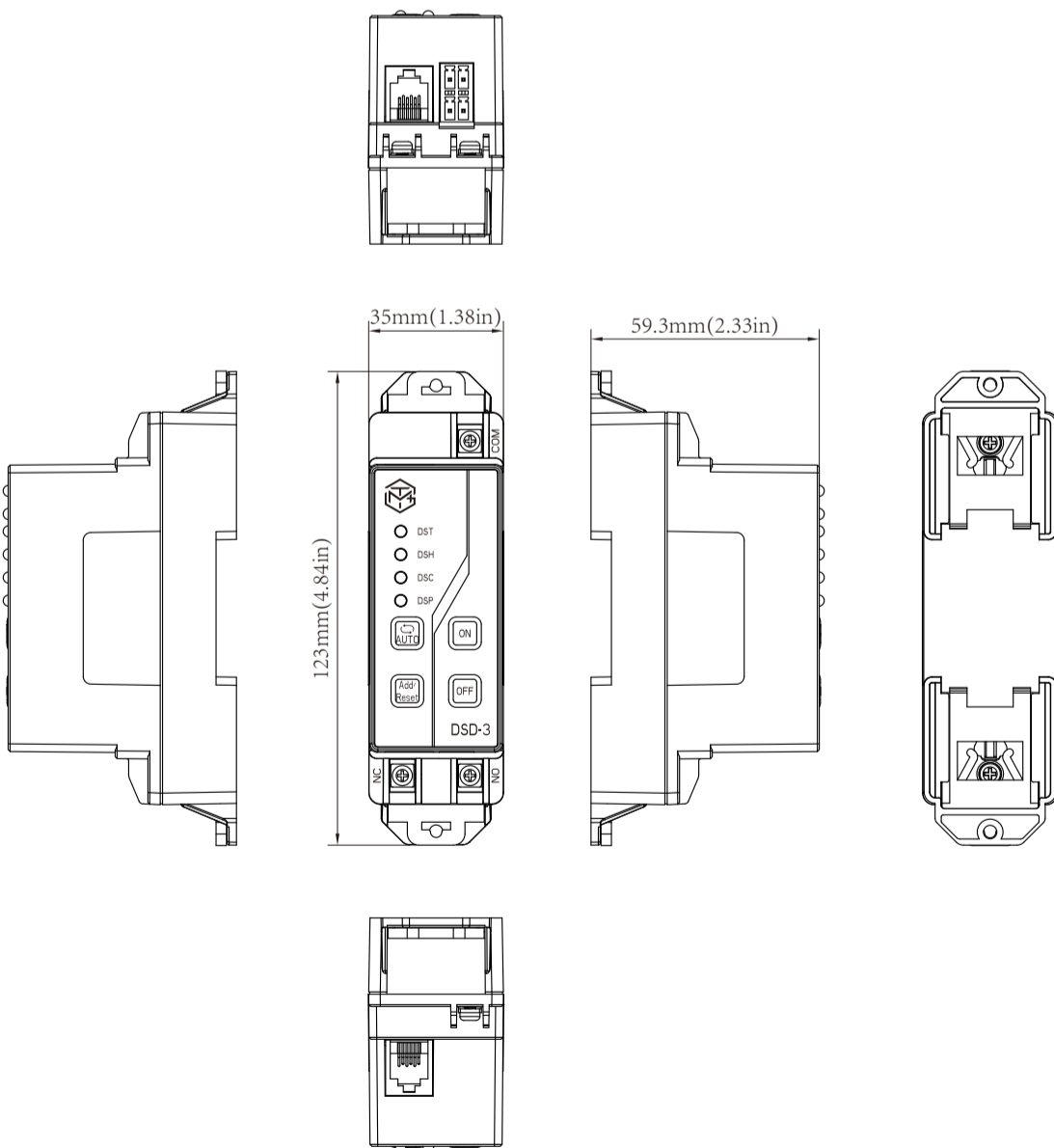

FC RoHS



For more details and to access full information, please click or scan the QR code above.

© 2026 TrolMaster Agro Instruments Co., Ltd. All rights reserved.

Email: support@trolmaster.com

Phone: 877-420-9876